



Imaged Document Cover Sheet

The document following this cover sheet is an imaged document supplied by LANDATA®, Secure Electronic Registries Victoria.

Document Type	Plan
Document Identification	RP018628
Number of Pages (excluding this cover sheet)	2
Document Assembled	25/08/2023 12:43

Copyright and disclaimer notice:

© State of Victoria. This publication is copyright. No part may be reproduced by any process except in accordance with the provisions of the Copyright Act 1968 (Cth) and for the purposes of Section 32 of the Sale of Land Act 1962 or pursuant to a written agreement. The information is only valid at the time and in the form obtained from the LANDATA® System. None of the State of Victoria, LANDATA®, Secure Electronic Registries Victoria Pty Ltd (ABN 86 627 986 396) as trustee for the Secure Electronic Registries Victoria Trust (ABN 83 206 746 897) accept responsibility for any subsequent release, publication or reproduction of the information.

The document is invalid if this cover sheet is removed or altered.

18628

Y

K197106

PLAN OF STRATA SUBDIVISION

18628
P.S.

THE PARCEL - The whole of the land described in Certificate of Title Volume 8989 Folio 769 being part of Crown Allotments 21 and 24 Section 81 Town and Parish of Stawell County of Borong * See below.

POSTAL ADDRESS OF BUILDINGS -
1 SLOANE STREET, STAWELL, 3380.

FOR CURRENT ADDRESS FOR SERVICE OF NOTICE
SEE OWNERS CORPORATION SEARCH REPORT

REGISTERED

TIME **8:55 A.M.**

DATE

15/2/1983

R.P.C.

18628

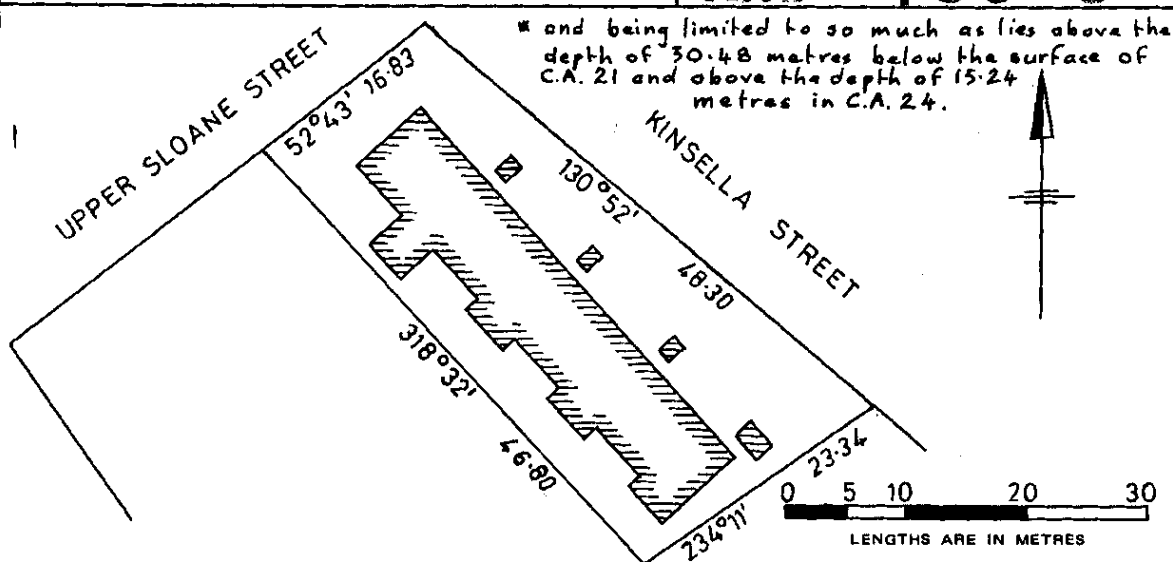

Diagram showing the external boundaries of the site and the location in relation thereto at ground level of all buildings in the parcel.

SURVEYOR'S CERTIFICATE

I, **Charles Edward Barry LIGHTFOOT**, of Stawell, a surveyor licensed under the Land Surveyors Act 1958 certify that this plan and any measurements on which it is based have been made by me or under my personal direction and supervision; that the standard of accuracy of any measurements made to determine the external boundaries of the site complies with the requirements of and under the Land Surveyors Act 1958; that the plan accurately represents as at

the 30th day of APRIL 1979

in the manner required by or under the Strata Titles Act 1967 and by or under the Land Surveyors Act 1958; and within the limitations of the scale used and the standard of accuracy required, the boundaries of the units and the location at ground level of all buildings in the parcel in relation to the external boundaries of the site; and that all units are within the parcel.

Signature C. E. Lightfoot Date 2/5/1979

SEAL OF MUNICIPALITY AND ENDORSEMENT

Sealed pursuant to Section 6 (i).
Strata Title Act

11th day of July 1979

[Signature]

SCHEDULE OF UNIT ENTITLEMENT AND UNIT LIABILITY

FOR CURRENT OWNERS CORPORATION DETAILS
SEE OWNERS CORPORATION SEARCH REPORT

Re-certified as at 14th December 1982.
C. E. Lightfoot

C. E. Lightfoot
Licensed Surveyor.

R.P. 18628

K197106 K197106

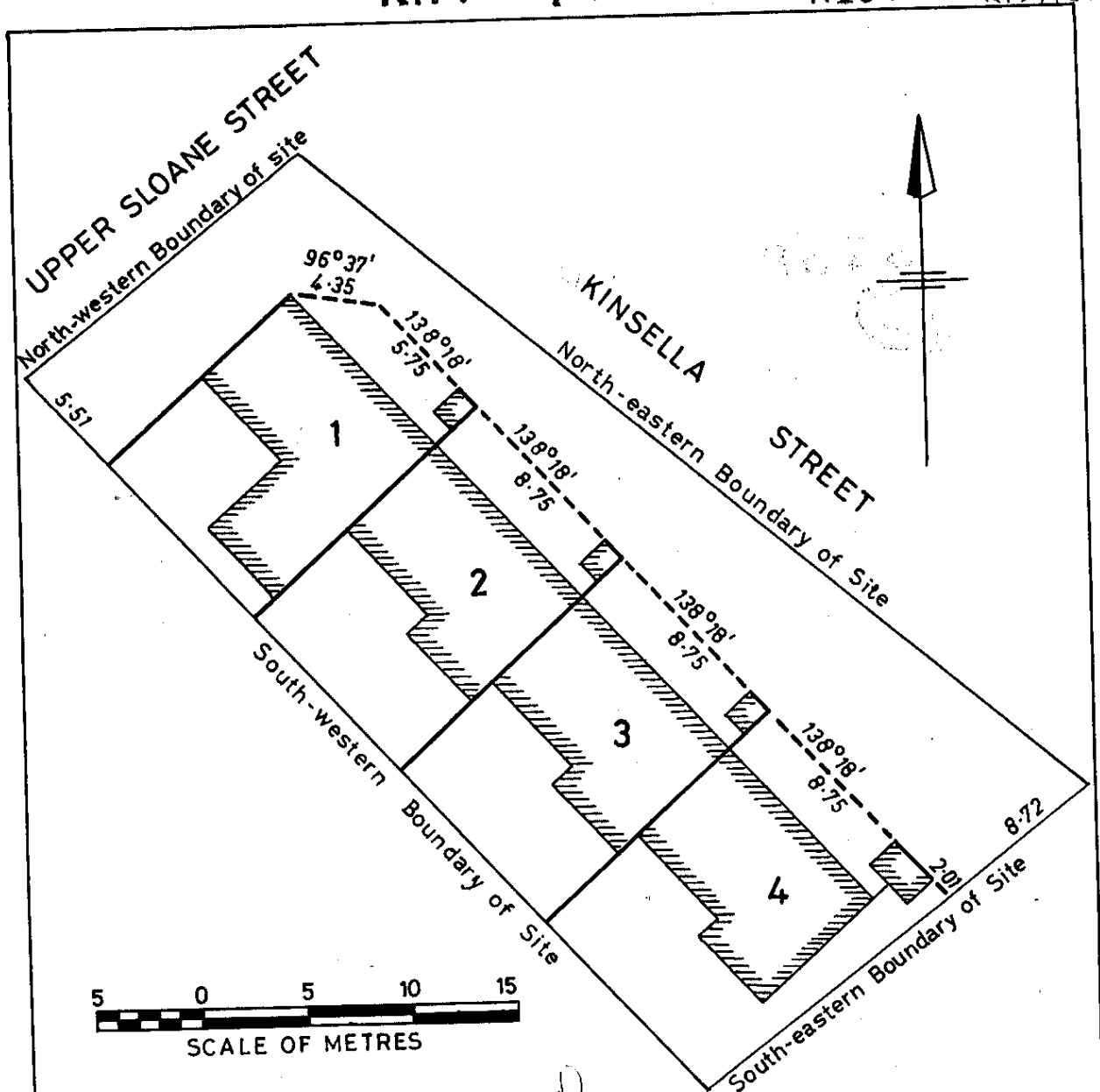

LEGEND.

The building in the parcel a part of which is contained in each of units 1 to 4 ^(both inclusive) is a single storey building. The buildings in the parcel which are wholly contained in units 1 to 4 (both inclusive) are single storey buildings.

The upper boundary of each of units 1 to 4 (both inclusive) is eight metres above that part of the site which is within the vertical or near vertical boundaries of the relevant unit as shown on the diagram on this sheet: the lower boundary of each of these units is one metre below that part of the site.

The common property is all the land in the parcel except the land in units 1 to 4 (both inclusive).

No unit on this Plan is an accessory unit.

LICENSED SURVEYOR
2nd. MAY 1979
SHEET 2 OF 2 SHEETS.

REF. 555.

8/31/83

(both inclusive)