



# Cosway Accounting

ABN: 29 066 100 880

Tax Agent – Business Advisor – MYOB Specialist

## Superfund Audit Checklist

CLIENT: **BRM SUPER FUND**

CODE: **RAWL23**

YEAR: **2020**

GST: YES / **(NO)**  
Please Circle

Prepared By: **Wayne**

Reviewed By: **Wayne**

Schedule Reference	INDEX	Tick if Applicable
A-1	Trust Deed	✓
A-2	Engagement Letter	✓
B-1	Investment Strategy	✓
B-2	Trustees Representation Letter	✓
C-1	Minutes of AGM	✓
D-1	Financial Statements	✓
E-1	Tax Return	✓
F-1	Bank Statements	✓
F-1	Bank Reconciliation	
G-1	Dividend Reconciliation	
H-1	Chess holdings	
I-1	Certificate of Titles (property)	
J	Rental Property	
J-1	- Lease Agreement	
J-2	- Income	
J-3	- Expenses	
K-1	Member Contribution Statements	✓

052/03147 009666



M & L RAWLINSON  
 LOT 75  
 GLIDDON RD  
 HOVEA WA 6071

**Your details at a glance**

<b>BSB number</b>	<b>633-000</b>
<b>Account number</b>	<b>121978456</b>
<b>Customer number</b>	<b>15094105/1201</b>
<b>Account title</b>	<b>M &amp; L RAWLINSON ATF THE BRM SUPER FUND AS TRUSTEE FOR THE BRM SUPER FUND</b>

**Account summary**

<b>Statement period</b>	<b>1 Jun 2020 - 30 Jun 2020</b>
<b>Statement number</b>	<b>195</b>
<b>Opening balance on 1 Jun 2020</b>	<b>\$14,930.05</b>
<b>Deposits &amp; credits</b>	<b>\$933.68</b>
<b>Withdrawals &amp; debits</b>	<b>\$1.40</b>
<b>Closing Balance on 30 Jun 2020</b>	<b>\$15,862.33</b>

# We're changing for the better

Introducing our new logo

**Any questions?**

Contact Justin Pires at 6945 Great Eastern Hwy, Mundaring 6073 on **08 9295 0744**, or call **1300 BENDIGO** (1300 236 344).

**Bendigo Business Cash Management**

Date	Transaction	Withdrawals	Deposits	Balance
<b>Opening balance</b>				<b>\$14,930.05</b>
1 Jun 20	INTEREST		0.00	14,930.05
1 Jun 20	<b>Monthly Transaction Summary</b>			
	CHEQUE WITHDRAWALS (2 @ 0.70)	1.40		
	<b>Total Transaction Fees</b>	<b>1.40</b>		
	<b>Net Transaction Fees for May 20</b>	<b>1.40</b>		<b>14,928.65</b>
15 Jun 20	DIRECT CREDIT ATO001000012787755 ATO 0978915730		480.94	15,409.59
17 Jun 20	DIRECT CREDIT ATO007000012196123 ATO 0979493089		78.68	15,488.27
19 Jun 20	DIRECT CREDIT ATO006000012373076 ATO 0980003579		374.06	15,862.33
<b>Transaction totals / Closing balance</b>		<b>\$1.40</b>	<b>\$933.68</b>	<b>\$15,862.33</b>

161BH119 / E-3147 / S-4516 / L-9035 / 0015094105076598



052/05368 009666



M & L RAWLINSON  
 LOT 75  
 GLIDDON RD  
 HOVEA WA 6071

**Your details at a glance**

<b>BSB number</b>	<b>633-000</b>
<b>Account number</b>	<b>121978456</b>
<b>Customer number</b>	15094105/1201
<b>Account title</b>	M & L RAWLINSON ATF THE BRM SUPER FUND AS TRUSTEE FOR THE BRM SUPER FUND

**Account summary**

<b>Statement period</b>	1 May 2020 - 31 May 2020
<b>Statement number</b>	194
<b>Opening balance on 1 May 2020</b>	\$13,729.09
<b>Deposits &amp; credits</b>	\$1,630.72
<b>Withdrawals &amp; debits</b>	\$429.76
<b>Closing Balance on 31 May 2020</b>	<b>\$14,930.05</b>

We're changing  
 for the better

Introducing our new logo



**Any questions?**

Contact Justin Pires at 6945 Great Eastern Hwy,  
 Mundaring 6073 on **08 9295 0744**, or call **1300 BENDIGO**

**Bendigo Business Cash Management**

<b>Date</b>	<b>Transaction</b>	<b>Withdrawals</b>	<b>Deposits</b>	<b>Balance</b>
<b>Opening balance</b>				<b>\$13,729.09</b>
1 May 20	INTEREST		0.00	13,729.09
1 May 20	<b>Monthly Transaction Summary</b>			
	CHEQUE WITHDRAWALS (1 @ 0.70)	0.70		
	<b>Total Transaction Fees</b>	<b>0.70</b>		
	<b>Net Transaction Fees for April 20</b>	<b>0.70</b>		13,728.39
1 May 20	DIRECT CREDIT ATO003000012154998 ATO 0970235181		78.66	13,807.05
1 May 20	CHEQUE 150	385.00		13,422.05
4 May 20	DIRECT CREDIT ATO008000012136781 ATO 0970535961		1,552.06	14,974.11
20 May 20	CHEQUE 152	44.06		14,930.05
<b>Transaction totals / Closing balance</b>		<b>\$429.76</b>	<b>\$1,630.72</b>	<b>\$14,930.05</b>

061BH106 / E-5368 / S-9717 / I-19433 / 0015094105030041

052/02216 009666



M & L RAWLINSON  
 LOT 75  
 GLIDDON RD  
 HOVEA WA 6071

**BSB number** 633-000  
**Account number** 121978456  
**Customer number** 15094105/1201  
**Account title** M & L RAWLINSON ATF THE BRM  
 SUPER FUND AS TRUSTEE FOR THE BRM SUPER  
 FUND

**Statement period** 1 Apr 2020 - 30 Apr 2020  
**Statement number** 193  
**Opening balance on 1 Apr 2020** \$14,753.92  
**Deposits & credits** \$130.87  
**Withdrawals & debits** \$1,155.70  
**Closing Balance on 30 Apr 2020** \$13,729.09

**Any questions?**

Contact Justin Pires at 6945 Great Eastern Hwy,  
 Mundaring 6073 on **08 9295 0744**, or call  
**1300 BENDIGO** (1300 236 344).



Date	Transaction	Withdrawals	Deposits	Balance
<b>Opening balance</b>				<b>\$14,753.92</b>
1 Apr 20	INTEREST		0.29	14,754.21
1 Apr 20	<b>Monthly Transaction Summary</b>			
	CHEQUE WITHDRAWALS (1 @ 0.70)	0.70		
	<b>Total Transaction Fees</b>	<b>0.70</b>		
	<b>Net Transaction Fees for March 20</b>	<b>0.70</b>		14,753.51
16 Apr 20	DIRECT CREDIT ATO003000012101203 ATO 0967155041		130.58	14,884.09
29 Apr 20	CHEQUE 151	1,155.00		13,729.09
<b>Transaction totals / Closing balance</b>		<b>\$1,155.70</b>	<b>\$130.87</b>	<b>\$13,729.09</b>

Bendigo Bank suggests you carefully check all entries on your statement. Apparent errors or possible unauthorised transactions are to be promptly reported to your branch. It is important that you notify Bendigo Bank of any disputed transactions as soon as possible as Bendigo Bank's ability to investigate disputed transactions and to subsequently process a chargeback in your favour is restricted by the time limits imposed under the operating rules of the applicable credit card scheme. If you wish to obtain further information about this product (including your chargeback rights) or you have a question or concern about your account or its operation please contact your local Bendigo Bank Branch (details supplied on the front of the statement).

962BH106 / E-2216 / S-3764 / H-7527 / 0015094105029817

052/06947 009666



M & L RAWLINSON  
 LOT 75  
 GLIDDON RD  
 HOVEA WA 6071

**Your details at a glance**

**BSB number** 633-000  
**Account number** 121978456  
**Customer number** 15094105/1201  
**Account title** M & L RAWLINSON ATF THE BRM  
 SUPER FUND AS TRUSTEE FOR THE BRM SUPER  
 FUND

**Account summary**

**Statement period** 1 Mar 2020 - 31 Mar 2020  
**Statement number** 192  
**Opening balance on 1 Mar 2020** \$14,543.17  
**Deposits & credits** \$254.81  
**Withdrawals & debits** \$44.06  
**Closing Balance on 31 Mar 2020** \$14,753.92

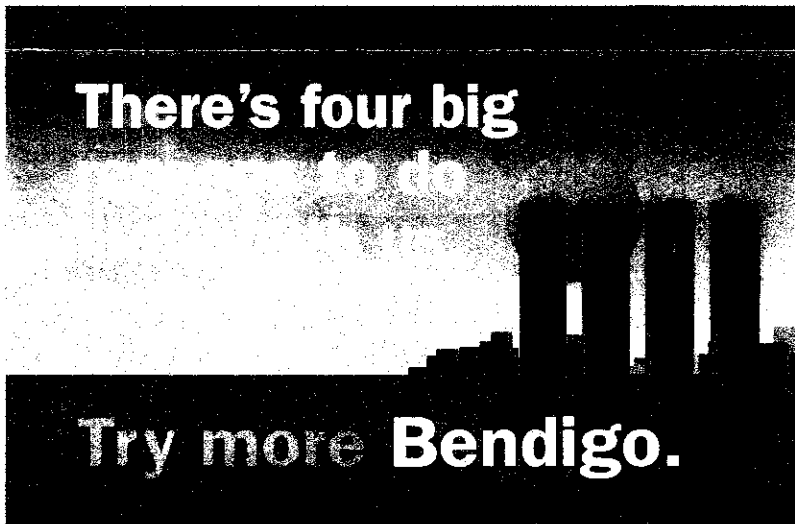

**Any questions?**

Contact Justin Pires at 6945 Great Eastern Hwy,  
 Mundaring 6073 on **08 9295 0744**, or call  
**1300 BENDIGO** (1300 236 344).

**Bendigo Business Cash Management**

Date	Transaction	Withdrawals	Deposits	Balance
<b>Opening balance</b>				<b>\$14,543.17</b>
1 Mar 20	INTEREST		0.57	14,543.74
1 Mar 20	Interest Rate	0.050%PA		
16 Mar 20	Interest Rate	0.000%PA		
19 Mar 20	CHEQUE 149	44.06		14,499.68
27 Mar 20	DIRECT CREDIT ATO008000012031716 ATO 0962957483		254.24	14,753.92
<b>Transaction totals / Closing balance</b>		<b>\$44.06</b>	<b>\$254.81</b>	<b>\$14,753.92</b>

Bendigo Bank suggests you carefully check all entries on your statement. Apparent errors or possible unauthorised transactions are to be promptly reported to your branch. It is important that you notify Bendigo Bank of any disputed transactions as soon as possible as Bendigo Bank's ability to investigate disputed transactions and to subsequently process a chargeback in your favour is restricted by the time limits imposed under the operating rules of the applicable credit card scheme. If you wish to obtain further information about this product (including your chargeback rights) or you have a question or concern about your account or its operation please contact your local Bendigo Bank Branch (details supplied on the front of the statement).

All card transactions made in currencies other than Australian dollars will incur a fee of 3% of the transaction value. (Additional charges may apply for cash transactions.)

...continued overleaf >

861BH107 / E-6947 / S-11306 / L-22611 / 0015094105032832

052/09182 009666



M & L RAWLINSON  
 LOT 75  
 GLIDDON RD  
 HOVEA WA 6071

**BSB number** 633-000  
**Account number** 121978456  
**Customer number** 15094105/1201  
**Account title** M & L RAWLINSON ATF THE BRM  
 SUPER FUND AS TRUSTEE FOR THE BRM SUPER  
 FUND

**Statement period** 1 Feb 2020 - 29 Feb 2020  
**Statement number** 191  
**Opening balance on 1 Feb 2020** \$14,289.04  
**Deposits & credits** \$254.83  
**Withdrawals & debits** \$0.70  
**Closing Balance on 29 Feb 2020** \$14,543.17

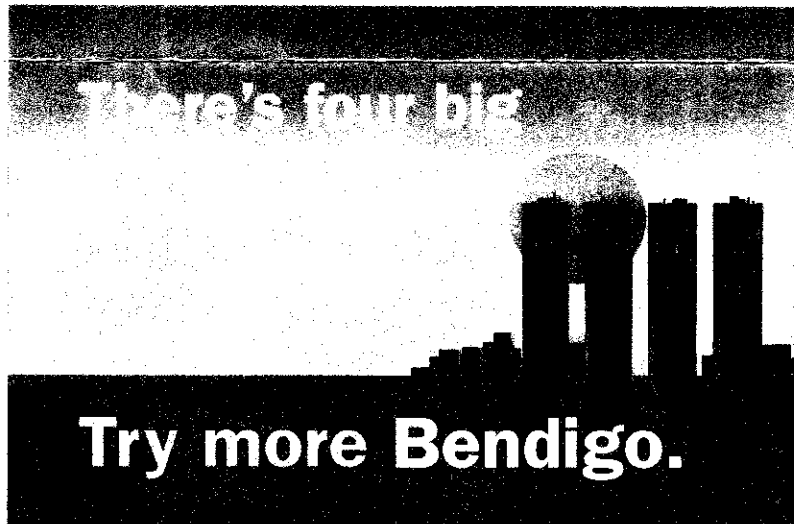

**Any questions?**

Contact Justin Pires at 6945 Great Eastern Hwy,  
 Mundaring 6073 on **08 9295 0744**, or call  
**1300 BENDIGO** (1300 236 344).

Date	Transaction	Withdrawals	Deposits	Balance
<b>Opening balance</b>				<b>\$14,289.04</b>
1 Feb 20	INTEREST		0.59	14,289.63
1 Feb 20	<b>Monthly Transaction Summary</b>			
	CHEQUE WITHDRAWALS (1 @ 0.70)	0.70		
	<b>Total Transaction Fees</b>	<b>0.70</b>		
	<b>Net Transaction Fees for January 20</b>	<b>0.70</b>		<b>14,288.93</b>
1 Feb 20	Interest Rate	0.050%PA		
28 Feb 20	DIRECT CREDIT ATO005000011785291 ATO 0957039093		254.24	14,543.17
<b>Transaction totals / Closing balance</b>		<b>\$0.70</b>	<b>\$254.83</b>	<b>\$14,543.17</b>

Bendigo Bank suggests you carefully check all entries on your statement. Apparent errors or possible unauthorised transactions are to be promptly reported to your branch. It is important that you notify Bendigo Bank of any disputed transactions as soon as possible as Bendigo Bank's ability to investigate disputed transactions and to subsequently process a chargeback in your favour is restricted by the time limits imposed under the operating rules of the applicable credit card scheme. If you wish to obtain further information about this product (including your chargeback rights) or you have a question or concern about your account or its operation please contact your local Bendigo Bank Branch (details supplied on the front of the statement).

744BH108 / E-9182 / S-17021 / I-34041 / 0015094105035410



052/02465 009666



M & L RAWLINSON  
 LOT 75  
 GLIDDON RD  
 HOVEA WA 6071

**BSB number** 633-000  
**Account number** 121978456  
**Customer number** 15094105/1201  
**Account title** M & L RAWLINSON ATF THE BRM  
 SUPER FUND AS TRUSTEE FOR THE BRM SUPER  
 FUND

for banking with Australia's  
 5th biggest retail bank.



**Statement period** 1 Jan 2020 - 31 Jan 2020  
**Statement number** 190  
**Opening balance on 1 Jan 2020** \$13,492.84  
**Deposits & credits** \$839.54  
**Withdrawals & debits** \$43.34  
**Closing Balance on 31 Jan 2020** \$14,289.04

**Any questions?**

Contact Justin Pires at 6945 Great Eastern Hwy,  
 Mundaring 6073 on **08 9295 0744**, or call  
**1300 BENDIGO** (1300 236 344).

Date	Transaction	Withdrawals	Deposits	Balance
<b>Opening balance</b>				<b>\$13,492.84</b>
1 Jan 20	INTEREST		0.57	13,493.41
1 Jan 20	Interest Rate	0.050%PA		
7 Jan 20	DIRECT CREDIT ATO005000011680399 ATO 0946292218		361.00	13,854.41
16 Jan 20	DIRECT CREDIT ATO008000011880285 ATO 0948241695		245.32	14,099.73
17 Jan 20	CHEQUE 148	43.34		14,056.39
31 Jan 20	DIRECT CREDIT ATO002000012078880 ATO 0951211747		232.65	14,289.04
<b>Transaction totals / Closing balance</b>		<b>\$43.34</b>	<b>\$839.54</b>	<b>\$14,289.04</b>

Bendigo Bank suggests you carefully check all entries on your statement. Apparent errors or possible unauthorised transactions are to be promptly reported to your branch. It is important that you notify Bendigo Bank of any disputed transactions as soon as possible as Bendigo Bank's ability to investigate disputed transactions and to subsequently process a chargeback in your favour is restricted by the time limits imposed under the operating rules of the applicable credit card scheme. If you wish to obtain further information about this product (including your chargeback rights) or you have a question or concern about your account or its operation please contact your local Bendigo Bank Branch (details supplied on the front of the statement).

...continued overleaf >

052/05427 009666



M & L RAWLINSON  
 LOT 75  
 GLIDDON RD  
 HOVEA WA 6071

**Your details at a glance**

**BSB number** 633-000  
**Account number** 121978456  
**Customer number** 15094105/1201  
**Account title** M & L RAWLINSON ATF THE BRM  
 SUPER FUND AS TRUSTEE FOR THE BRM SUPER  
 FUND

**Account summary**

**Statement period** 1 Dec 2019 - 31 Dec 2019  
**Statement number** 189  
**Opening balance on 1 Dec 2019** \$13,041.76  
**Deposits & credits** \$451.78  
**Withdrawals & debits** \$0.70  
**Closing Balance on 31 Dec 2019** \$13,492.84

For banking with Australia's  
**5th biggest retail bank.**

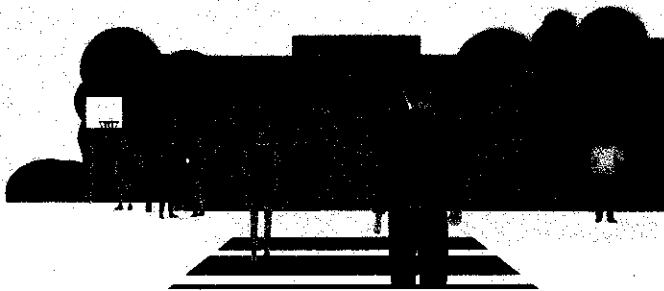

**Any questions?**

Contact Justin Pires at 6945 Great Eastern Hwy,  
 Mundaring 6073 on **08 9295 0744**, or call  
**1300 BENDIGO** (1300 236 344).

**Bendigo Business Cash Management**

Date	Transaction	Withdrawals	Deposits	Balance
	<b>Opening balance</b>			<b>\$13,041.76</b>
1 Dec 19	INTEREST		0.53	13,042.29
1 Dec 19	<b>Monthly Transaction Summary</b>			
	CHEQUE WITHDRAWALS (1 @ 0.70)	0.70		
	<b>Total Transaction Fees</b>	<b>0.70</b>		
	<b>Net Transaction Fees for November 19</b>	<b>0.70</b>		13,041.59
1 Dec 19	Interest Rate	0.050%PA		
3 Dec 19	DIRECT CREDIT ATO005000011629220 ATO 0939375162		451.25	13,492.84
<b>Transaction totals / Closing balance</b>		<b>\$0.70</b>	<b>\$451.78</b>	<b>\$13,492.84</b>

Bendigo Bank suggests you carefully check all entries on your statement. Apparent errors or possible unauthorised transactions are to be promptly reported to your branch. It is important that you notify Bendigo Bank of any disputed transactions as soon as possible as Bendigo Bank's ability to investigate disputed transactions and to subsequently process a chargeback in your favour is restricted by the time limits imposed under the operating rules of the applicable credit card scheme. If you wish to obtain further information about this product (including your chargeback rights) or you have a question or concern about your account or its operation please contact your local Bendigo Bank Branch (details supplied on the front of the statement).

543BH119 / E-5427 / S-8127 / I-16253 / 0015094105079614



052/09737 009666



M & L RAWLINSON  
 LOT 75  
 GLIDDON RD  
 HOVEA WA 6071

**Your details at a glance**

**BSB number** 633-000  
**Account number** 121978456  
**Customer number** 15094105/1201  
**Account title** M & L RAWLINSON ATF THE BRM  
 SUPER FUND AS TRUSTEE FOR THE BRM SUPER  
 FUND

**Account summary**

**Statement period** 1 Nov 2019 - 30 Nov 2019  
**Statement number** 188  
**Opening balance on 1 Nov 2019** \$12,611.73  
**Deposits & credits** \$474.09  
**Withdrawals & debits** \$44.06  
**Closing Balance on 30 Nov 2019** \$13,041.76

**Thank you**  
 for banking with Bendigo Bank's  
**5th biggest retail bank.**



**Any questions?**

Contact Gerry Toovey at 6945 Great Eastern Hwy,  
 Mundaring 6073 on **08 9295 0744**, or call  
**1300 BENDIGO** (1300 236 344).

**Bendigo Business Cash Management**

Date	Transaction	Withdrawals	Deposits	Balance
<b>Opening balance</b>				<b>\$12,611.73</b>
1 Nov 19	INTEREST		0.52	12,612.25
1 Nov 19	DIRECT CREDIT ATO006000011570132 ATO 0932872112		228.26	12,840.51
1 Nov 19	Interest Rate	0.050%PA		
18 Nov 19	CHEQUE 147	44.06		12,796.45
29 Nov 19	DIRECT CREDIT ATO006000011729111 ATO 0938643448		245.31	13,041.76
<b>Transaction totals / Closing balance</b>		<b>\$44.06</b>	<b>\$474.09</b>	<b>\$13,041.76</b>

Bendigo Bank suggests you carefully check all entries on your statement. Apparent errors or possible unauthorised transactions are to be promptly reported to your branch. It is important that you notify Bendigo Bank of any disputed transactions as soon as possible as Bendigo Bank's ability to investigate disputed transactions and to subsequently process a chargeback in your favour is restricted by the time limits imposed under the operating rules of the applicable credit card scheme. If you wish to obtain further information about this product (including your chargeback rights) or you have a question or concern about your account or its operation please contact your local Bendigo Bank Branch (details supplied on the front of the statement).

All card transactions made in currencies other than Australian dollars will incur a fee of 3% of the transaction value. (Additional charges may apply for cash transactions.)

444BH107 / E-9737 / S-18738 / M37475 / 0015094105039857

052/02825 009666



M & L RAWLINSON  
 LOT 75  
 GLIDDON RD  
 HOVEA WA 6071

**Your details at a glance**

**BSB number** 633-000  
**Account number** 121978456  
 Customer number 15094105/1201  
**Account title** M & L RAWLINSON ATF THE BRM  
 SUPER FUND AS TRUSTEE FOR THE BRM SUPER  
 FUND

**Account summary**

**Statement period** 1 Oct 2019 - 31 Oct 2019  
**Statement number** 187  
**Opening balance on 1 Oct 2019** \$11,800.39  
**Deposits & credits** \$812.74  
**Withdrawals & debits** \$1.40  
**Closing Balance on 31 Oct 2019** \$12,611.73

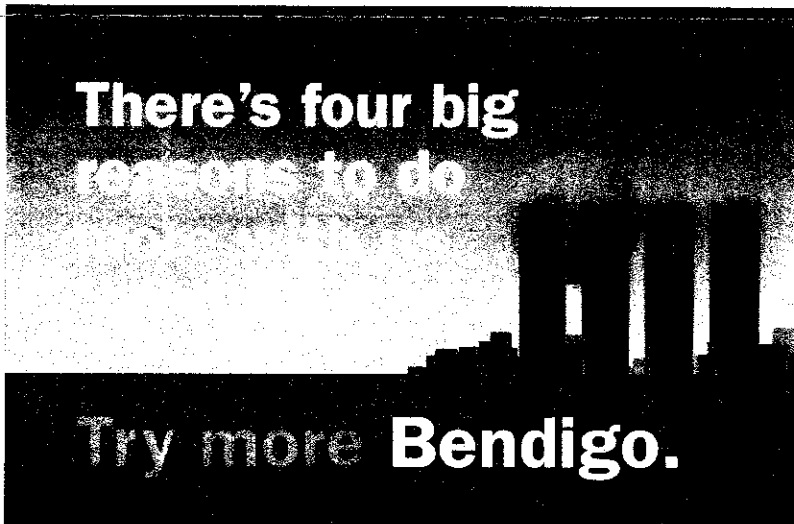

**Any questions?**

Contact Gerry Toovey at 6945 Great Eastern Hwy,  
 Mundaring 6073 on **08 9295 0744**, or call  
**1300 BENDIGO** (1300 236 344).

**Bendigo Business Cash Management**

Date	Transaction	Withdrawals	Deposits	Balance
<b>Opening balance</b>				<b>\$11,800.39</b>
1 Oct 19	INTEREST		0.49	11,800.88
1 Oct 19	<b>Monthly Transaction Summary</b>			
	CHEQUE WITHDRAWALS (2 @ 0.70)	1.40		
	<b>Total Transaction Fees</b>	<b>1.40</b>		
	<b>Net Transaction Fees for September 19</b>	<b>1.40</b>		<b>11,799.48</b>
1 Oct 19	DIRECT CREDIT ATO001000011893862 ATO 0926135673		451.25	12,250.73
1 Oct 19	Interest Rate 0.050%PA			
31 Oct 19	DIRECT CREDIT ATO006000011570133 ATO 0932531793		361.00	12,611.73
<b>Transaction totals / Closing balance</b>		<b>\$1.40</b>	<b>\$812.74</b>	<b>\$12,611.73</b>

341BH107 / E-2825 / S-5173 / I-10345 / 0015094105030896

052/00001 009666



M & L RAWLINSON  
 LOT 75  
 GLIDDON RD  
 HOVEA WA 6071

**Your details at a glance**

**BSB number** 633-000  
**Account number** 121978456  
**Customer number** 15094105/1201  
**Account title** M & L RAWLINSON ATF THE BRM  
 SUPER FUND AS TRUSTEE FOR THE BRM SUPER  
 FUND

**Account summary**

**Statement period** 1 Sep 2019 - 30 Sep 2019  
**Statement number** 186  
**Opening balance on 1 Sep 2019** \$12,756.98  
**Deposits & credits** \$607.47  
**Withdrawals & debits** \$1,564.06  
**Closing Balance on 30 Sep 2019** \$11,800.39

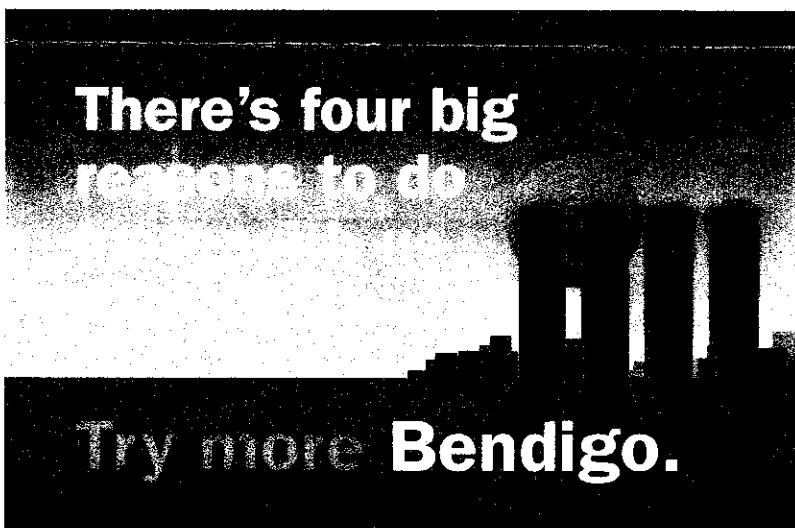

**Any questions?**

Contact Gerry Toovey at 6945 Great Eastern Hwy, Mundaring 6073 on **08 9295 0744**, or call **1300 BENDIGO** (1300 236 344).

**Bendigo Business Cash Management**

Date	Transaction	Withdrawals	Deposits	Balance
<b>Opening balance</b>				<b>\$12,756.98</b>
1 Sep 19	INTEREST		0.53	12,757.51
1 Sep 19	Interest Rate	0.050%PA		
3 Sep 19	DIRECT CREDIT ATO009000011259182 ATO 0920114833		361.00	13,118.51
5 Sep 19	CHEQUE 145	1,520.00		11,598.51
13 Sep 19	CHEQUE 146	44.06		11,554.45
27 Sep 19	DIRECT CREDIT ATO001100011131816 ATO 0925378334		245.94	11,800.39
<b>Transaction totals / Closing balance</b>		<b>\$1,564.06</b>	<b>\$607.47</b>	<b>\$11,800.39</b>

Bendigo Bank suggests you carefully check all entries on your statement. Apparent errors or possible unauthorised transactions are to be promptly reported to your branch. It is important that you notify Bendigo Bank of any disputed transactions as soon as possible as Bendigo Bank's ability to investigate disputed transactions and to subsequently process a chargeback in your favour is restricted by the time limits imposed under the operating rules of the applicable credit card scheme. If you wish to obtain further information about this product (including your chargeback rights) or you have a question or concern about your account or its operation please contact your local Bendigo Bank Branch (details supplied on the front of the statement).

...continued overleaf >

232BH108 / E-1 / S-1 / H-1 / 0015094105033453

052/05636 009666



M & L RAWLINSON  
 LOT 75  
 GLIDDON RD  
 HOVEA WA 6071

**Your details at a glance**

**BSB number** 633-000  
**Account number** 121978456  
 Customer number 15094105/1201  
**Account title** M & L RAWLINSON ATF THE BRM  
 SUPER FUND AS TRUSTEE FOR THE BRM SUPER  
 FUND

**Account summary**

**Statement period** 1 Aug 2019 - 31 Aug 2019  
**Statement number** 185  
**Opening balance on 1 Aug 2019** \$12,544.49  
**Deposits & credits** \$213.19  
**Withdrawals & debits** \$0.70  
**Closing Balance on 31 Aug 2019** \$12,756.98

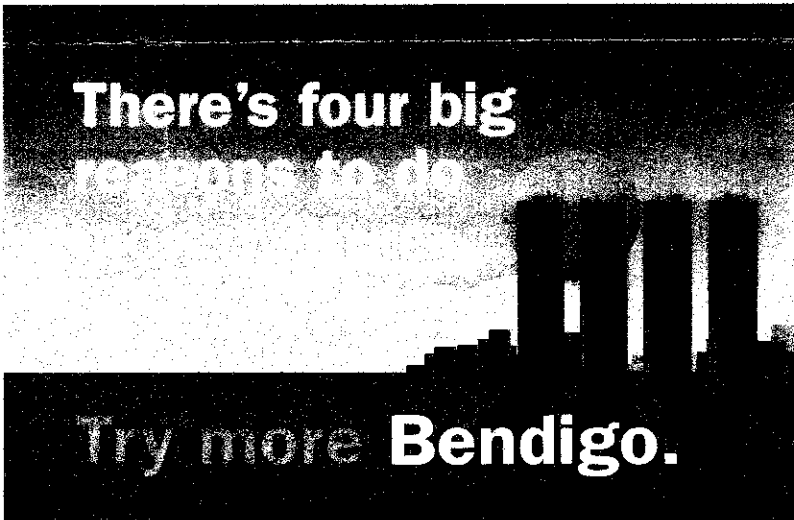

**Any questions?**

Contact Gerry Toovey at 6945 Great Eastern Hwy, Mundaring 6073 on **08 9295 0744**, or call **1300 BENDIGO** (1300 236 344).

**Bendigo Business Cash Management**

Date	Transaction	Withdrawals	Deposits	Balance
<b>Opening balance</b>				<b>\$12,544.49</b>
1 Aug 19	INTEREST		0.50	12,544.99
1 Aug 19	<b>Monthly Transaction Summary</b>			
	CHEQUE WITHDRAWALS (1 @ 0.70)	0.70		
	<b>Total Transaction Fees</b>	<b>0.70</b>		
	<b>Net Transaction Fees for July 19</b>	<b>0.70</b>		12,544.29
1 Aug 19	Interest Rate	0.050%PA		
30 Aug 19	DIRECT CREDIT ATO001000011722836 ATO 0919406665		212.69	12,756.98
<b>Transaction totals / Closing balance</b>		<b>\$0.70</b>	<b>\$213.19</b>	<b>\$12,756.98</b>

Bendigo Bank suggests you carefully check all entries on your statement. Apparent errors or possible unauthorised transactions are to be promptly reported to your branch. It is important that you notify Bendigo Bank of any disputed transactions as soon as possible as Bendigo Bank's ability to investigate disputed transactions and to subsequently process a chargeback in your favour is restricted by the time limits imposed under the operating rules of the applicable credit card scheme. If you wish to obtain further information about this product (including your chargeback rights) or you have a question or concern about your account or its operation please contact your local Bendigo Bank Branch (details supplied on the front of the statement).

...continued overleaf >

132BH107 / E-5636 / S-9829 / I-19657 / 0015094105035960

052/07081 009666



M & L RAWLINSON  
 LOT 75  
 GLIDDON RD  
 HOVEA WA 6071

**Your details at a glance**

**BSB number** 633-000  
**Account number** 121978456  
 Customer number 15094105/1201  
**Account title** M & L RAWLINSON ATF THE BRM  
 SUPER FUND AS TRUSTEE FOR THE BRM SUPER  
 FUND

**Account summary**

**Statement period** 1 Jul 2019 - 31 Jul 2019  
**Statement number** 184  
**Opening balance on 1 Jul 2019** \$9,903.72  
**Deposits & credits** \$2,686.25  
**Withdrawals & debits** \$45.48  
**Closing Balance on 31 Jul 2019** \$12,544.49

**Any questions?**

Contact Gerry Toovey at 6945 Great Eastern Hwy,  
 Mundaring 6073 on **08 9295 0744**, or call  
**1300 BENDIGO** (1300 236 344).



**Bendigo Business Cash Management**

Date	Transaction	Withdrawals	Deposits	Balance
<b>Opening balance</b>				<b>\$9,903.72</b>
1 Jul 19	INTEREST		0.40	9,904.12
1 Jul 19	<b>Monthly Transaction Summary</b>			
	CHEQUE WITHDRAWALS (1 @ 0.70)	0.70		
	<b>Total Transaction Fees</b>	<b>0.70</b>		
	<b>Net Transaction Fees for June 19</b>	<b>0.70</b>		9,903.42
1 Jul 19	Interest Rate	0.050%PA		
3 Jul 19	DIRECT CREDIT ATO005000010532405 ATO 0907069022		1,985.50	11,888.92
17 Jul 19	DIRECT CREDIT ATO001100010496971 ATO 0909911892		145.82	12,034.74
17 Jul 19	CHEQUE 144	44.78		11,989.96
26 Jul 19	DIRECT CREDIT ATO009000010880032 ATO 0911996908		193.53	12,183.49
31 Jul 19	DIRECT CREDIT ATO005000010856534 ATO 0912929607		361.00	12,544.49
<b>Transaction totals / Closing balance</b>		<b>\$45.48</b>	<b>\$2,686.25</b>	<b>\$12,544.49</b>

...continued overleaf >

030BH107 / E-7081 / S-11965 / K23929 / 0015094105032138



# Cosway Accounting

ABN: 29 066 100 880

Tax Agent – Business Advisor – MYOB Specialist

## TAX INVOICE

*BRM Super Fund*  
75 Gliddon Road  
Hovea WA 6071

**Invoice Date**  
13 April 2020

**Invoice No.**  
6580

**Invoice Due Date -**  
20 April 2020

**Client Code**  
RAWL23

**To our Professional Fees and Charges in attending to the following :-**

Preparing Super Fund Annual Accounts including Member Statements and Tax Returns,  
Preparation of Audit Papers ready for auditors for the year ended 30th June 2019, filing Tax  
Returns with the ATO, advising on taxation position.

Our Fee Total  
Plus: GST  
**TOTAL FEE**

*PAID 20/4/20*  
*CHQ NUMBER 151*

	1,050.00
	105.00
	<hr/>
	\$1,155.00
	<hr/>



F 000427



BRM SUPER FUND  
75 GLIDDON RD  
HOVEA WA 6071

Our reference: 2602197235482

Phone: 13 11 42

Client ID: 76 482 613 977

31 July 2020

## We're here to help

- > Here is your account information
- > You can choose from different payment or support options

To whom it may concern,

We understand that there are challenging circumstances that can make it difficult to lodge or pay on time and we are here to help.

You should continue to lodge on time, even if you can't pay by the due date. This will help us understand your total tax position. If you have trouble lodging on time we can help.

If you need help with paying we have a range of support options available to assist you. Visit [ato.gov.au/helpwithpaying](http://ato.gov.au/helpwithpaying) to find out more.

If you have paid the total balance or entered a payment plan in the last seven days, you don't need to do anything else. To find out how to view a detailed breakdown of each account, visit [ato.gov.au/howmuchyouowe](http://ato.gov.au/howmuchyouowe)

Here are the details of the amount outstanding on your Income Tax account.

Account type	Amount owing
Income Tax/ 551	\$269.20 ✓

For more information you can visit [ato.gov.au/managingpayments](http://ato.gov.au/managingpayments) to help you stay on track.

Yours faithfully,  
Melinda Smith  
Deputy Commissioner of Taxation

PAID 18/8/2020  
Bendigo CHQ No. 155

### NEED HELP?

We can help you with your questions about how to pay or any other tax matter, support is available online.

If you can't pay, you may be able to set up a payment plan online.

To find more information on payment plans, visit [ato.gov.au/helpwithpaying](http://ato.gov.au/helpwithpaying)

If you have any questions, you can phone us on 13 11 42 between 8:00am and 5:00pm, Monday to Friday.



# SUPER AUDITS

## TAX INVOICE

**Supplier:** Super Audits

**Auditor:** A.W. Boys  
SMSF Auditor Number (SAN) 100014140  
Registered Company Auditor (67793)

**Address:** Box 3376  
Rundle Mall 5000

**ABN:** 20 461 503 652

**Services:** Auditing

**Date:** 13 April 2020

**Recipient:** BRM Super Fund

**Address:** C/- PO Box 1900, MIDLAND W.A. 6963

PAID 24/3/20  
CHQ NUMBER 150

### Description of Services

Statutory audit of the BRM Super Fund for the financial year ending 30 June 2019.

**Fee:** \$350.00

**GST:** \$35.00

**Total:** \$385.00

Payment can be made with a cheque payable to Super Audits postal address being Box 3376 Rundle Mall 5000 or alternatively an EFT can be made BSB 015-056 Account No. 387392386.

AUDITING  
DUE DILIGENCE  
FORENSIC ACCOUNTING

Liability limited by a scheme approved under Professional Standards Legislation

☎ 23 154 028 216 📦 Box 3376, Rundle Mall SA 5000 📞 0410 712 708 ✉ tony.boys32@gmail.com 🌐 www.superaudits.com.au





# Shire of Toodyay

CUSTOMER COPY

ABN 97 352 024 603  
 COUNCIL OFFICE: 15 FIENNES STREET, TOODYAY, W.A.  
 POST OFFICE BOX 96, TOODYAY, 6566  
 TELEPHONE: (08) 9574 9300 FACSIMILE: (08) 9574 2158  
 Email: records@toodyay.wa.gov.au Web: www.toodyay.wa.gov.au  
 OFFICE HOURS: 8.30 a.m. - 4.30 p.m. Monday - Friday

## TAX INVOICE / RECEIPT

185524

Payer:

RAWLINSON M  
 AS TRUSTEES FOR THE BRM SUPER FUND  
 75 GLIDDON STREET  
 HOVEA WA 6071

DATE

04.09.19

DATE	DESCRIPTION	AMOUNT
	Rates Receipts A3173 - 41 JUBILEE STREET TOODYAY WA 6566	\$1,520.00
* GST Exclusive Charge \$1,520.00 * GST \$0.00		<b>AMOUNT RECEIVED</b>
		<b>\$1,520.00</b>

Cash	Cheque	Other
\$0.00	\$1,520.00	\$0.00

Tendered	\$1,520.00
Change Given	\$0.00
Round Amount	\$0.00

TRISSETT BOSS BUSINESS FORMS (08) 9242 1980 6308

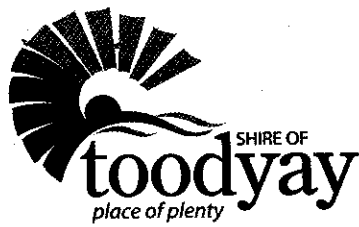

# Shire of Toodyay

COUNCIL OFFICE: 15 FIENNES STREET, TOODYAY, W.A. POST  
 OFFICE BOX 96, TOODYAY, 6566  
 TELEPHONE: (08) 9574 9300 FACSIMILE: (08) 9574 2158  
 Email: records@toodyay.wa.gov.au Web: www.toodyay.wa.gov.au  
 OFFICE HOURS: 8.30 a.m. - 4.30 p.m. Monday to Friday

**TAX INVOICE**  
 SHIRE OF TOODYAY  
 - ABC 97 852 024 603  
 RECEIVED  
 06.08.2019

## RATE NOTICE

FOR YEAR ENDING  
 30TH JUNE 2020

CHIEF EXECUTIVE OFFICER  
**STAN SCOTT**

DATE ISSUED  
 06.08.2019

ASSESSMENT NUMBER  
 A3173

IF THE ADDRESS  
 IS INCORRECT  
 PLEASE COMPLETE  
 ADVICE OF CHANGE  
 OVERLEAF

MARCUS RAWLINSON  
 LIZA RAWLINSON  
 AS TRUSTEES FOR THE BRM SUPER FUND  
 75 GLIDDON STREET  
 HOVEA WA 6071

Other Owners - schedule attached

**NOTICE OF VALUATION AND RATE, LOCAL GOVERNMENT ACT 1995 AND HEALTH ACT 1911**  
 NOTICE IS HEREBY GIVEN THAT THE COUNCIL OF THE SHIRE OF TOODYAY HAS ORDERED AND DIRECTED THAT THE UNDERMENTIONED  
 LAND OF WHICH YOU ARE THE OWNER IS VALUED AND RATED AS HEREIN SPECIFIED.

DETAILS OF RATED PROPERTY		41 JUBILEE STREET		WARD		CENTRAL	
LOTS/LOCATIONS OR OTHER INFORMATION		350/546					
ZONE		RESIDENTIAL		USE T-VACANT			
VALUATION		\$1,650.00 - GRV		RATING DETAIL		DUE DATE 10.09.2019	
MINIMUM RATE		\$1,351.00		RATE IN \$ OR CHARGE PER SERVICE		CURRENT	
				ARREARS		TOTAL	
GRV RESIDENTIAL		12.9430		\$1,351.00		\$1,351.00	
Emergency Services Levy		0.5194		\$84.00		\$1,435.00	
ESL Category 4, Property Use Vacant, GRV \$1,650							
WASTE TRANSFER STATION RATE		1@85.00		\$85.00		\$1,520.00	
GST is nil							

### PAYMENT OPTIONS

DUE DATE 10.09.2019 **\$ \$1,520.00**

**OPTION 1** PAYMENT DUE - IF PAID IN FULL

**OPTION 2** PAYMENT BY FOUR SET INSTALMENTS

INSTALMENT CHARGE \$	\$32.99	1ST INSTALMENT	DUE DATE	10.09.2019	\$ \$452.29
		2ND INSTALMENT	DUE DATE	12.11.2019	\$ \$366.90
		3RD INSTALMENT	DUE DATE	14.01.2020	\$ \$366.90
		4TH INSTALMENT	DUE DATE	17.03.2020	\$ \$366.90
TOTAL COST \$	\$1,552.99				

**NOTE: 1ST INSTALMENT INCLUDES ALL ARREARS OF RATES AND CHARGES & SERVICE CHARGES**

POSTAL REMITTANCES: NO RECEIPT WILL BE ISSUED UNLESS:

(1) THE NOTICE IS RETURNED INTACT WITH REMITTANCE AND (2) THIS BOX IS TICKED

**SEE OVER FOR MORE IMPORTANT INFORMATION**

## Service Charge Account

Issue date 2 July 2019

Bill ID 0084

Account number 90 07937 30 7

Please pay \$44.78

Payment due by 18 Jul 2019

052N 000386 000000

L & M RAWLINSON  
ATF BRM SUPER FUND  
75 GLIDDON RD  
HOVEA WA 6071

Account for VACANT LAND (RES) AT 41 JUBILEE ST TOODYAY LOT 546

### Your account summary (GST does not apply to this account)

Description	Amount
Service charges due 18 July 2019	\$44.78
Turn over for important information	Total \$44.78

Interest is charged on overdue amounts @ 11.71% p.a.

### Payment slip

#### Enquiries?

Need your account in an alternative format?

Please call us on 13 13 85.

#### Need more time to pay?

Visit [watercorporation.com.au/financialassistance](http://watercorporation.com.au/financialassistance)  
or call 1300 659 752.

#### Hearing or speech impaired?

Phone us via the National Relay Service on 133 677.

Website: [watercorporation.com.au/contact](http://watercorporation.com.au/contact)

Faults and Emergencies: (24/7) 13 13 75

41 JUBILEE ST TOODYAY LOT 546

Account number 90 07937 30 7

Please pay \$44.78

Payment due by 18 July 2019



## Service Charge Account

Issue date 3 September 2019  
 Bill ID 0085  
 Account number 90 07937 30 7  
 Please pay \$44.06  
 Payment due by 19 Sep 2019

052N 000849 000000

L & M RAWLINSON  
 ATF BRM SUPER FUND  
 75 GLIDDON RD  
 HOVEA WA 6071

Account for VACANT LAND (RES) AT 41 JUBILEE ST TOODYAY LOT 546

### Your account summary (GST does not apply to this account)

Description	Amount
Service charges due 19 September 2019	\$44.06
Turn over for important information <span style="float: right;">Total</span>	\$44.06

Interest is charged on overdue amounts @ 11.71% p.a.

### Payment slip

**Enquiries?**  
 Need your account in an alternative format?  
 Please call us on 13 13 85.

Need more time to pay?  
 Visit [watercorporation.com.au/financialassistance](http://watercorporation.com.au/financialassistance)  
 or call 1300 659 752.

**Hearing or speech impaired?**  
 Phone us via the National Relay Service on 133 677.  
**Website:** [watercorporation.com.au/contact](http://watercorporation.com.au/contact)  
**Faults and Emergencies:** (24/7) 13 13 75

41 JUBILEE ST TOODYAY LOT 546

Account number 90 07937 30 7  
 Please pay \$44.06  
 Payment due by 19 September 2019

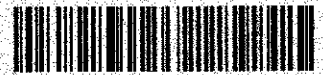

## Service Charge Account

Issue date 4 November 2019  
 Bill ID 0086  
 Account number 90 07937 30 7  
 Please pay \$44.06  
 Payment due by 20 Nov 2019

052N 001089 000000

L & M RAWLINSON  
 ATF BRM SUPER FUND  
 75 GLIDDON RD  
 HOVEA WA 6071

Account for VACANT LAND (RES) AT 41 JUBILEE ST TOODYAY LOT 546

### Your account summary (GST does not apply to this account)

Description	Amount
Service charges due 20 November 2019	\$44.06
Turn over for important information	Total \$44.06

Interest is charged on overdue amounts @ 11.71% p.a.

### Payment slip

**Enquiries?**  
 Need your account in an alternative format?  
 Please call us on 13 13 85.

Need more time to pay?  
 Visit [watercorporation.com.au/financialassistance](http://watercorporation.com.au/financialassistance)  
 or call 13 13 85.

Hearing or speech impaired?  
 Please use the National Relay Service on 133 677.  
 Website: [watercorporation.com.au/contact](http://watercorporation.com.au/contact)  
 Faults and Emergencies: (24/7) 13 13 75

41 JUBILEE ST TOODYAY LOT 546

Account number 90 07937 30 7  
 Please pay \$44.06  
 Payment due by 20 November 2019



## Service Charge Account

Issue date 3 January 2020  
Bill ID 0087

052N 000180 000000

L & M RAWLINSON  
ATF BRM SUPER FUND  
75 GLIDDON RD  
HOVEA WA 6071

Account number **90 07937 30 7**  
Please pay **\$43.34**  
Payment due by **20 Jan 2020**

Account for VACANT LAND (RES) AT 41 JUBILEE ST TOODYAY LOT 546

### Your account summary (GST does not apply to this account)

Description	Amount
Service charges due 20 January 2020	\$43.34
Turn over for important information	Total \$43.34

Interest is charged on overdue amounts @ 11.71% p.a.

### Payment slip

**Enquiries?**  
**Need your account in an alternative format?**  
Please call us on 13 13 85.

**Need more time to pay?**  
Visit [watercorporation.com.au/financialassistance](http://watercorporation.com.au/financialassistance)  
or call 1300 659 752.

**Hearing or speech impaired?**  
Phone us via the National Relay Service on 133 677.  
**Website:** [watercorporation.com.au/contact](http://watercorporation.com.au/contact)  
**Faults and Emergencies:** (24/7) 13 13 75

41 JUBILEE ST TOODYAY LOT 546

Account number **90 07937 30 7**  
Please pay **\$43.34**  
Payment due by **20 January 2020**



**Service Charge Account**

Issue date 4 March 2020  
 Bill ID 0088  
 Account number 90 07937 30 7  
 Please pay \$44.06  
 Payment due by 20 Mar 2020

052N 002910 000000

L & M RAWLINSON  
 ATF BRM SUPER FUND  
 75 GLIDDON RD  
 HOVEA WA 6071

Account for VACANT LAND (RES) AT 41 JUBILEE ST TOODYAY LOT 546

**Your account summary (GST does not apply to this account)**

Description	Amount
Service charges due 20 March 2020	\$44.06
<b>Turn over for important information</b>	<b>Total \$44.06</b>

Interest is charged on overdue amounts @ 11.71% p.a.

**Payment slip**

41 JUBILEE ST TOODYAY LOT 546

Account number 90 07937 30 7  
 Please pay \$44.06  
 Payment due by 20 March 2020

**Enquiries?**  
 Need your account in an alternative format?  
 Please call us on 13 13 85.

Need more time to pay?  
 Visit [watercorporation.com.au/financialassistance](http://watercorporation.com.au/financialassistance)  
 or call 1300 659 752.

**Hearing or speech impaired?**  
 Phone us via the National Relay Service on 133 677.

**Website:** [watercorporation.com.au/contact](http://watercorporation.com.au/contact)  
**Faults and Emergencies:** (24/7) 13 13 75



## Service Charge Account

Issue date 4 May 2020  
Bill ID 0089

Account number 90 07937 30 7  
Please pay \$44.06  
Payment due by 20 May 2020

052N 000976 000000

L & M RAWLINSON  
ATF BRM SUPER FUND  
75 GLIDDON RD  
HOVEA WA 6071

Account for VACANT LAND (RES) AT 41 JUBILEE ST TOODYAY LOT 546

### Your account summary (GST does not apply to this account)

Description	Amount
Service charges due 20 May 2020	\$44.06
Turn over for important information	Total \$44.06

Interest is charged on overdue amounts @ 11.71% p.a.

### Payment slip

**Enquiries?**  
Need your account in an alternative format?  
Please call us on 13 13 85.

Need more time to pay?  
Visit [watercorporation.com.au/financialassistance](http://watercorporation.com.au/financialassistance)  
or call 1300 659 752.

**Hearing or speech impaired?**  
Phone us via the National Relay Service on 133 677.  
**Website:** [watercorporation.com.au/contact](http://watercorporation.com.au/contact)  
**Faults and Emergencies:** (24/7) 13 13 75

41 JUBILEE ST TOODYAY LOT 546

Account number 90 07937 30 7  
Please pay \$44.06  
Payment due by 20 May 2020

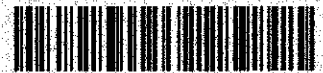





052

MRS LISA RAWLINSON  
75 GLIDDON RD  
HOVEA WA 6071

Reply to: PO Box 3578  
ALBURY NSW 2640  
Our reference: 7112677141073  
Phone: 13 10 20  
TFN: 625 931 667

4 October 2019

## Payment to your superannuation account

Dear MRS RAWLINSON

On 12 July 2019 we transferred contributions of \$145.82 to your account 2, managed by BRM SUPER FUND.

This payment includes the following contributions:

Employer	Quarter End Date	Amount \$
KINGKRAFT SHEETMETAL PTY LTD	30 September 2016	128.67
KINGKRAFT SHEETMETAL PTY LTD	31 December 2016	17.15

These are the quarterly superannuation contributions your employer makes on your behalf to a complying super fund or retirement savings account; and failing that, to the Tax Office.

In your case, they have paid us this contribution. We have checked our records and found you have an account with them that we can transfer the money to.

We will also transfer any future contributions we receive to this account unless you send us the details of a different account.

There may be a difference between the amount we transferred and the amount we received from your employer/s. This could be because:

- your employer changed the amount owed to you
- your employer provided new information which changed the amount we can pay you
- we used some or all of the amount to reduce the amount owing on your super guarantee account, or
- an amount previously sent to your super fund was returned to the ATO.

You can find more information about your superannuation entitlements on our website at [www.ato.gov.au/super](http://www.ato.gov.au/super)



MRS LISA RAWLINSON  
75 GLIDDON RD  
HOVEA WA 6071

Reply to: PO Box 3578  
ALBURY NSW 2640  
Our reference: 7112821506613  
Phone: 13 10 20  
TFN: 625 931 667

15 October 2019

## Payment to your superannuation account

Dear MRS RAWLINSON

On 23 July 2019 we transferred contributions of \$193.53 to your account 2, managed by BRM SUPER-FUND.

This payment includes the following contributions:

Employer	Quarter End Date	Amount \$
KINGKRAFT SHEETMETAL PTY LTD	31 December 2016	193.53

These are the quarterly superannuation contributions your employer makes on your behalf to a complying super fund or retirement savings account; and failing that, to the Tax Office.

In your case, they have paid us this contribution. We have checked our records and found you have an account with them that we can transfer the money to.

We will also transfer any future contributions we receive to this account unless you send us the details of a different account.

There may be a difference between the amount we transferred and the amount we received from your employer/s. This could be because:

- your employer changed the amount owed to you
- your employer provided new information which changed the amount we can pay you
- we used some or all of the amount to reduce the amount owing on your super guarantee account, or
- an amount previously sent to your super fund was returned to the ATO.

You can find more information about your superannuation entitlements on our website at [www.ato.gov.au/super](http://www.ato.gov.au/super)

If you have any questions about this payment, please phone **13 10 20** between 8.00am and 6.00pm, Monday to Friday, and quote 'Our reference' and your tax file number or Australian business number.

Yours sincerely

Melinda Smith  
Deputy Commissioner of Taxation



052

MRS LISA RAWLINSON  
75 GLIDDON RD  
HOVEA WA 6071

Reply to: PO Box 3578  
ALBURY NSW 2640  
Our reference: 7113354492409  
Phone: 13 10 20  
TFN: 625 931 667

19 November 2019

## Payment to your superannuation account

Dear MRS RAWLINSON

On 27 August 2019 we transferred contributions of \$212.69 to your account 2, managed by BRM SUPER FUND.

This payment includes the following contributions:

Employer	Quarter End Date	Amount \$
KINGKRAFT SHEETMETAL PTY LTD	31 December 2016	15.21
KINGKRAFT SHEETMETAL PTY LTD	31 March 2017	197.48

These are the quarterly superannuation contributions your employer makes on your behalf to a complying super fund or retirement savings account; and failing that, to the Tax Office.

In your case, they have paid us this contribution. We have checked our records and found you have an account with them that we can transfer the money to.

We will also transfer any future contributions we receive to this account unless you send us the details of a different account.

There may be a difference between the amount we transferred and the amount we received from your employer/s. This could be because:

- your employer changed the amount owed to you
- your employer provided new information which changed the amount we can pay you
- we used some or all of the amount to reduce the amount owing on your super guarantee account, or
- an amount previously sent to your super fund was returned to the ATO.

You can find more information about your superannuation entitlements on our website at [www.ato.gov.au/super](http://www.ato.gov.au/super)



052

MRS LISA RAWLINSON  
75 GLIDDON RD  
HOVEA WA 6071

Reply to: PO Box 3578  
ALBURY NSW 2640  
Our reference: 7113839757694  
Phone: 13 10 20  
TFN: 625 931 667

17 December 2019

## Payment to your superannuation account

Dear MRS RAWLINSON

On 24 September 2019 we transferred contributions of \$245.94 to your account 2, managed by BRM SUPER FUND.

This payment includes the following contributions:

Employer	Quarter End Date	Amount \$
KINGKRAFT SHEETMETAL PTY LTD	31 March 2017	245.94

These are the quarterly superannuation contributions your employer makes on your behalf to a complying super fund or retirement savings account; and failing that, to the Tax Office.

In your case, they have paid us this contribution. We have checked our records and found you have an account with them that we can transfer the money to.

We will also transfer any future contributions we receive to this account unless you send us the details of a different account.

There may be a difference between the amount we transferred and the amount we received from your employer/s. This could be because:

- your employer changed the amount owed to you
- your employer provided new information which changed the amount we can pay you
- we used some or all of the amount to reduce the amount owing on your super guarantee account, or
- an amount previously sent to your super fund was returned to the ATO.

You can find more information about your superannuation entitlements on our website at [www.ato.gov.au/super](http://www.ato.gov.au/super)

If you have any questions about this payment, please phone **13 10 20** between 8.00am and 6.00pm, Monday to Friday, and quote 'Our reference' and your tax file number or Australian business number.

Yours sincerely

Melinda Smith  
Deputy Commissioner of Taxation



052

MRS LISA RAWLINSON  
75 GLIDDON RD  
HOVEA WA 6071

**Reply to:** PO Box 3578  
ALBURY NSW 2640  
**Our reference:** 7114264801300  
**Phone:** 13 10 20  
**TFN:** 625 931 667

24 January 2020

## Payment to your superannuation account

Dear MRS RAWLINSON

On 29 October 2019 we transferred contributions of \$228.26 to your account 2, managed by BRM SUPER FUND.

This payment includes the following contributions:

Employer	Quarter End Date	Amount \$
KINGKRAFT SHEETMETAL PTY LTD	31 March 2017	205.25
KINGKRAFT SHEETMETAL PTY LTD	30 June 2017	23.01

These are the quarterly superannuation contributions your employer makes on your behalf to a complying super fund or retirement savings account; and failing that, to the Tax Office.

In your case, they have paid us this contribution. We have checked our records and found you have an account with them that we can transfer the money to.

We will also transfer any future contributions we receive to this account unless you send us the details of a different account.

There may be a difference between the amount we transferred and the amount we received from your employer/s. This could be because:

- your employer changed the amount owed to you
- your employer provided new information which changed the amount we can pay you
- we used some or all of the amount to reduce the amount owing on your super guarantee account, or
- an amount previously sent to your super fund was returned to the ATO.

You can find more information about your superannuation entitlements on our website at [www.ato.gov.au/super](http://www.ato.gov.au/super)



052

MRS LISA RAWLINSON  
75 GLIDDON RD  
HOVEA WA 6071

Reply to: PO Box 3578  
ALBURY NSW 2640  
Our reference: 7114676604480  
Phone: 13 10 20  
TFN: 625 931 667

24 February 2020

## Payment to your superannuation account

Dear MRS RAWLINSON

On 26 November 2019 we transferred contributions of \$245.31 to your account 2, managed by BRM SUPER FUND.

This payment includes the following contributions:

Employer	Quarter End Date	Amount \$
KINGKRAFT SHEETMETAL PTY LTD	30 June 2017	245.31

These are the quarterly superannuation contributions your employer makes on your behalf to a complying super fund or retirement savings account; and failing that, to the Tax Office.

In your case, they have paid us this contribution. We have checked our records and found you have an account with them that we can transfer the money to.

We will also transfer any future contributions we receive to this account unless you send us the details of a different account.

There may be a difference between the amount we transferred and the amount we received from your employer/s. This could be because:

- your employer changed the amount owed to you
- your employer provided new information which changed the amount we can pay you
- we used some or all of the amount to reduce the amount owing on your super guarantee account, or
- an amount previously sent to your super fund was returned to the ATO.

You can find more information about your superannuation entitlements on our website at [www.ato.gov.au/super](http://www.ato.gov.au/super)

If you have any questions about this payment, please phone **13 10 20** between 8.00am and 6.00pm, Monday to Friday, and quote 'Our reference' and your tax file number or Australian business number.

Yours sincerely

Melinda Smith  
Deputy Commissioner of Taxation



052

MRS LISA RAWLINSON  
75 GLIDDON RD  
HOVEA WA 6071

**Reply to:** PO Box 3578  
ALBURY NSW 2640  
**Our reference:** 7115218867028  
**Phone:** 13 10 20  
**TFN:** 625 931 667

7 April 2020

## Payment to your superannuation account

Dear MRS RAWLINSON

On 13 January 2020 we transferred contributions of \$245.32 to your account 2, managed by BRM SUPER FUND.

This payment includes the following contributions:

Employer	Quarter End Date	Amount \$
KINGKRAFT SHEETMETAL PTY LTD	30 June 2017	245.32

These are the quarterly superannuation contributions your employer makes on your behalf to a complying super fund or retirement savings account; and failing that, to the Tax Office.

In your case, they have paid us this contribution. We have checked our records and found you have an account with them that we can transfer the money to.

We will also transfer any future contributions we receive to this account unless you send us the details of a different account.

There may be a difference between the amount we transferred and the amount we received from your employer/s. This could be because:

- your employer changed the amount owed to you
- your employer provided new information which changed the amount we can pay you
- we used some or all of the amount to reduce the amount owing on your super guarantee account, or
- an amount previously sent to your super fund was returned to the ATO.

You can find more information about your superannuation entitlements on our website at [www.ato.gov.au/super](http://www.ato.gov.au/super)

If you have any questions about this payment, please phone **13 10 20** between 8.00am and 6.00pm, Monday to Friday, and quote 'Our reference' and your tax file number or Australian business number.

Yours sincerely

Melinda Smith  
Deputy Commissioner of Taxation



052

MRS LISA RAWLINSON  
75 GLIDDON RD  
HOVEA WA 6071

Reply to: PO Box 3578  
ALBURY NSW 2640  
Our reference: 7115446374667  
Phone: 13 10 20  
TFN: 625 931 667

23 April 2020

## Payment to your superannuation account

Dear MRS RAWLINSON

On 28 January 2020 we transferred contributions of \$232.65 to your account 2, managed by BRM SUPER FUND.

This payment includes the following contributions:

Employer	Quarter End Date	Amount \$
KINGKRAFT SHEETMETAL PTY LTD	30 June 2017	117.77
KINGKRAFT SHEETMETAL PTY LTD	30 September 2017	114.88

These are the quarterly superannuation contributions your employer makes on your behalf to a complying super fund or retirement savings account; and failing that, to the Tax Office.

In your case, they have paid us this contribution. We have checked our records and found you have an account with them that we can transfer the money to.

We will also transfer any future contributions we receive to this account unless you send us the details of a different account.

There may be a difference between the amount we transferred and the amount we received from your employer/s. This could be because:

- your employer changed the amount owed to you
- your employer provided new information which changed the amount we can pay you
- we used some or all of the amount to reduce the amount owing on your super guarantee account, or
- an amount previously sent to your super fund was returned to the ATO.

You can find more information about your superannuation entitlements on our website at [www.ato.gov.au/super](http://www.ato.gov.au/super)





MRS LISA RAWLINSON  
75 GLIDDON RD  
HOVEA WA 6071

Reply to: PO Box 3578  
ALBURY NSW 2640  
Our reference: 7115814798351  
Phone: 13 10 20  
TFN: 625 931 667

21 May 2020

## Payment to your superannuation account

Dear MRS RAWLINSON

On 25 February 2020 we transferred contributions of \$254.24 to your account 2, managed by BRM SUPER FUND.

This payment includes the following contributions:

Employer	Quarter End Date	Amount \$
KINGKRAFT SHEETMETAL PTY LTD	30 September 2017	254.24

These are the quarterly superannuation contributions your employer makes on your behalf to a complying super fund or retirement savings account; and failing that, to the Tax Office.

In your case, they have paid us this contribution. We have checked our records and found you have an account with them that we can transfer the money to.

We will also transfer any future contributions we receive to this account unless you send us the details of a different account.

There may be a difference between the amount we transferred and the amount we received from your employer/s. This could be because:

- your employer changed the amount owed to you
- your employer provided new information which changed the amount we can pay you
- we used some or all of the amount to reduce the amount owing on your super guarantee account, or
- an amount previously sent to your super fund was returned to the ATO.

You can find more information about your superannuation entitlements on our website at [www.ato.gov.au/super](http://www.ato.gov.au/super)

If you have any questions about this payment, please phone **13 10 20** between 8.00am and 6.00pm, Monday to Friday, and quote 'Our reference' and your tax file number or Australian business number.

Yours sincerely

Melinda Smith  
Deputy Commissioner of Taxation



052

MRS LISA RAWLINSON  
75 GLIDDON RD  
HOVEA WA 6071

Reply to: PO Box 3578  
ALBURY NSW 2640  
Our reference: 7116131510449  
Phone: 13 10 20  
TFN: 625 931 667

18 June 2020

## Payment to your superannuation account

Dear MRS RAWLINSON

On 24 March 2020 we transferred contributions of \$254.24 to your account 2, managed by BRM SUPER FUND.

This payment includes the following contributions:

Employer	Quarter End Date	Amount \$
KINGKRAFT SHEETMETAL PTY LTD	30 September 2017	254.24

These are the quarterly superannuation contributions your employer makes on your behalf to a complying super fund or retirement savings account; and failing that, to the Tax Office.

In your case, they have paid us this contribution. We have checked our records and found you have an account with them that we can transfer the money to.

We will also transfer any future contributions we receive to this account unless you send us the details of a different account.

There may be a difference between the amount we transferred and the amount we received from your employer/s. This could be because:

- your employer changed the amount owed to you
- your employer provided new information which changed the amount we can pay you
- we used some or all of the amount to reduce the amount owing on your super guarantee account, or
- an amount previously sent to your super fund was returned to the ATO.

You can find more information about your superannuation entitlements on our website at [www.ato.gov.au/super](http://www.ato.gov.au/super)

If you have any questions about this payment, please phone **13 10 20** between 8.00am and 6.00pm, Monday to Friday, and quote 'Our reference' and your tax file number or Australian business number.

Yours sincerely

Melinda Smith  
Deputy Commissioner of Taxation



052

MRS LISA RAWLINSON  
75 GLIDDON RD  
HOVEA WA 6071

**Reply to:** PO Box 3578  
ALBURY NSW 2640  
**Our reference:** 7116365692589  
**Phone:** 13 10 20  
**TFN:** 625 931 667

6 July 2020

## Payment to your superannuation account

Dear MRS RAWLINSON

On 10 April 2020 we transferred contributions of \$130.58 to your account 2, managed by BRM SUPER FUND.

This payment includes the following contributions:

Employer	Quarter End Date	Amount \$
KINGKRAFT SHEETMETAL PTY LTD	30 September 2017	130.58

These are the quarterly superannuation contributions your employer makes on your behalf to a complying super fund or retirement savings account; and failing that, to the Tax Office.

In your case, they have paid us this contribution. We have checked our records and found you have an account with them that we can transfer the money to.

We will also transfer any future contributions we receive to this account unless you send us the details of a different account.

There may be a difference between the amount we transferred and the amount we received from your employer/s. This could be because:

- your employer changed the amount owed to you
- your employer provided new information which changed the amount we can pay you
- we used some or all of the amount to reduce the amount owing on your super guarantee account, or
- an amount previously sent to your super fund was returned to the ATO.

You can find more information about your superannuation entitlements on our website at [www.ato.gov.au/super](http://www.ato.gov.au/super)

If you have any questions about this payment, please phone **13 10 20** between 8.00am and 6.00pm, Monday to Friday, and quote 'Our reference' and your tax file number or Australian business number.

Yours sincerely

Melinda Smith  
Deputy Commissioner of Taxation



052

MRS LISA RAWLINSON  
75 GLIDDON RD  
HOVEA WA 6071

Reply to: PO Box 3578  
ALBURY NSW 2640  
Our reference: 7116910606853  
Phone: 13 10 20  
TFN: 625 931 667

21 July 2020

## Payment to your superannuation account

Dear MRS RAWLINSON

On 28 April 2020 we transferred contributions of \$78.66 to your account 2, managed by BRM SUPER FUND.

This payment includes the following contributions:

Employer	Quarter End Date	Amount \$
KINGKRAFT SHEETMETAL PTY LTD	30 September 2017	78.66

These are the quarterly superannuation contributions your employer makes on your behalf to a complying super fund or retirement savings account; and failing that, to the Tax Office.

In your case, they have paid us this contribution. We have checked our records and found you have an account with them that we can transfer the money to.

We will also transfer any future contributions we receive to this account unless you send us the details of a different account.

There may be a difference between the amount we transferred and the amount we received from your employer/s. This could be because:

- your employer changed the amount owed to you
- your employer provided new information which changed the amount we can pay you
- we used some or all of the amount to reduce the amount owing on your super guarantee account, or
- an amount previously sent to your super fund was returned to the ATO.

You can find more information about your superannuation entitlements on our website at [www.ato.gov.au/super](http://www.ato.gov.au/super)

If you have any questions about this payment, please phone **13 10 20** between 8.00am and 6.00pm, Monday to Friday, and quote 'Our reference' and your tax file number or Australian business number.

Yours sincerely

Melinda Smith  
Deputy Commissioner of Taxation